

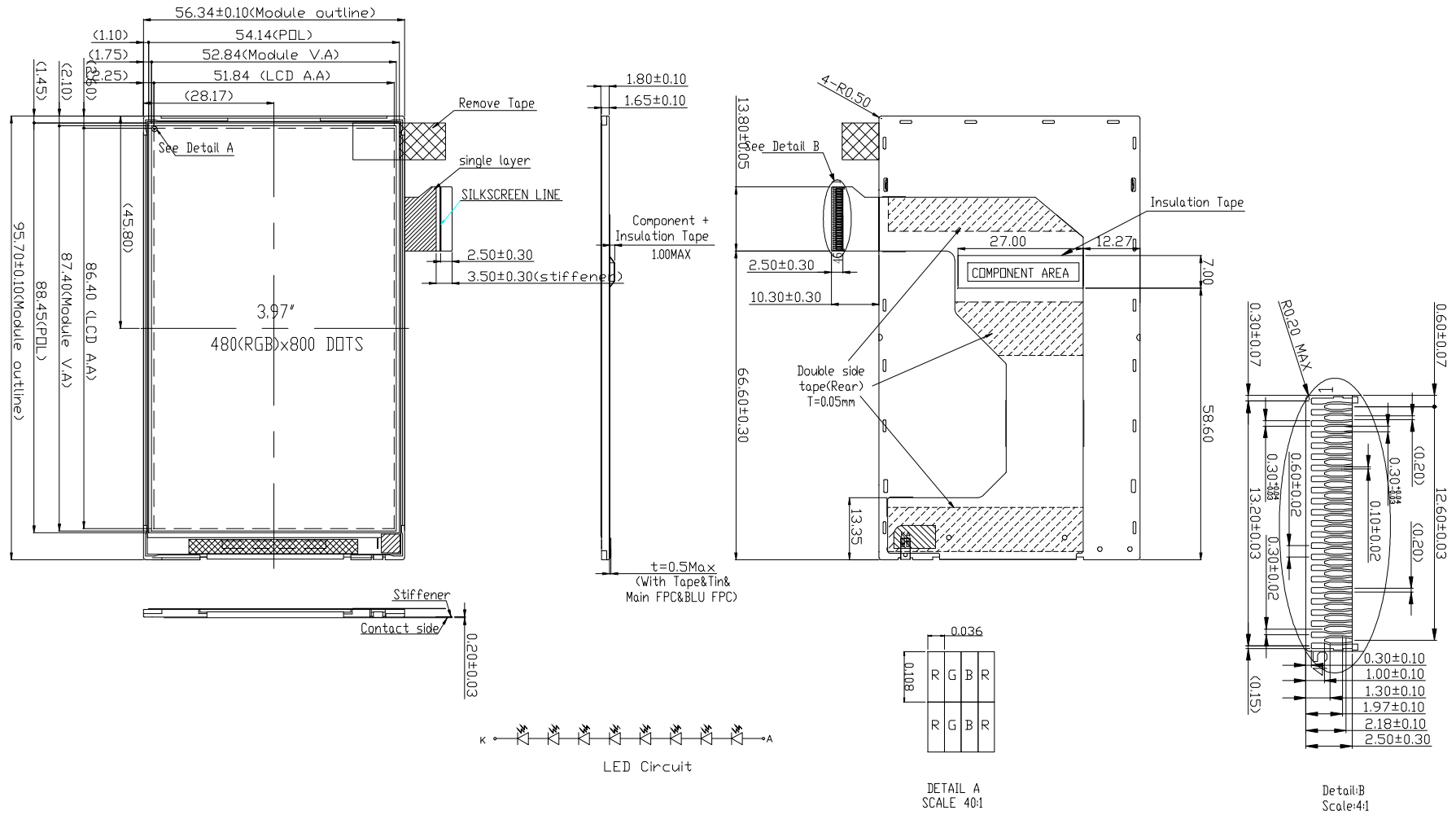

PIN	SYMBOL
1	GND
2	LEDA
3	LEDK
4	VCC
5	IDVCC
6	SDD
7	SDI
8	GND
9	SCL_WR
10	CS
11	IM3(NC)
12	RESET
13	R0
14	R1
15	R2
16	R3
17	R4
18	R5
19	R6
20	R7
21	G0
22	G1
23	G2
24	G3
25	G4
26	G5
27	G6
28	G7
29	B0
30	B1
31	B2
32	B3
33	B4
34	B5
35	B6
36	B7
37	DE
38	GND
39	PLK
40	GND
41	HS
42	VS
43	IC_ID(IDVCC)
44	LEN_PWN
45	GND



NOTES:

1. Display Type:TFT-IPS
2. Corresponding connector:H26-45S-0.35HW
3. Driver IC: HX8369A
4. Backlight:8-chips LED
5. General Tolerance:±0.2
6. Requirements on Environmental Protection:RoHS Compliant.
7. Recommended Case Open Area should be less than Module V.A

CUSTOMER APVL	CUSTOMER	DATE	
DRAWN	SCALE	TITLE	
DFTG_CHK	UNIT	MI0400FT-2	
ENGR_CHK	mm	MODEL	
APPROVAL			
MULTI-INNO TECHNOLOGY CO.,LTD.		DWG NO	PAGE
			1/1