

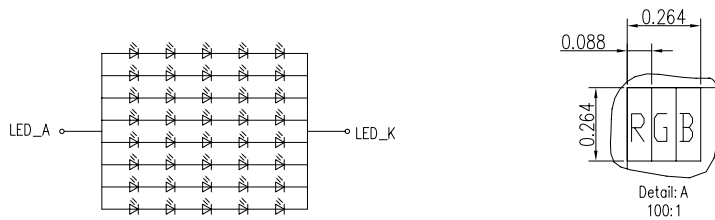

CN1		CN2	
Pin No.	Symbol	Pin No.	Symbol
1	VDD	1	VCC
2	VDD	2	GND
3	GND	3	EN
4	DPS	4	Dimming
5	RxIN0-	5	NC
6	RxIN0+		
7	GND		
8	RxIN1-		
9	RxIN1+		
10	GND		
11	RxIN2-		
12	RxIN2+		
13	GND		
14	RxCLKIN-		
15	RxCLKIN+		
16	GND		
17	RxIN3-		
18	RxIN3+		
19	AC Mode		
20	SEL68		

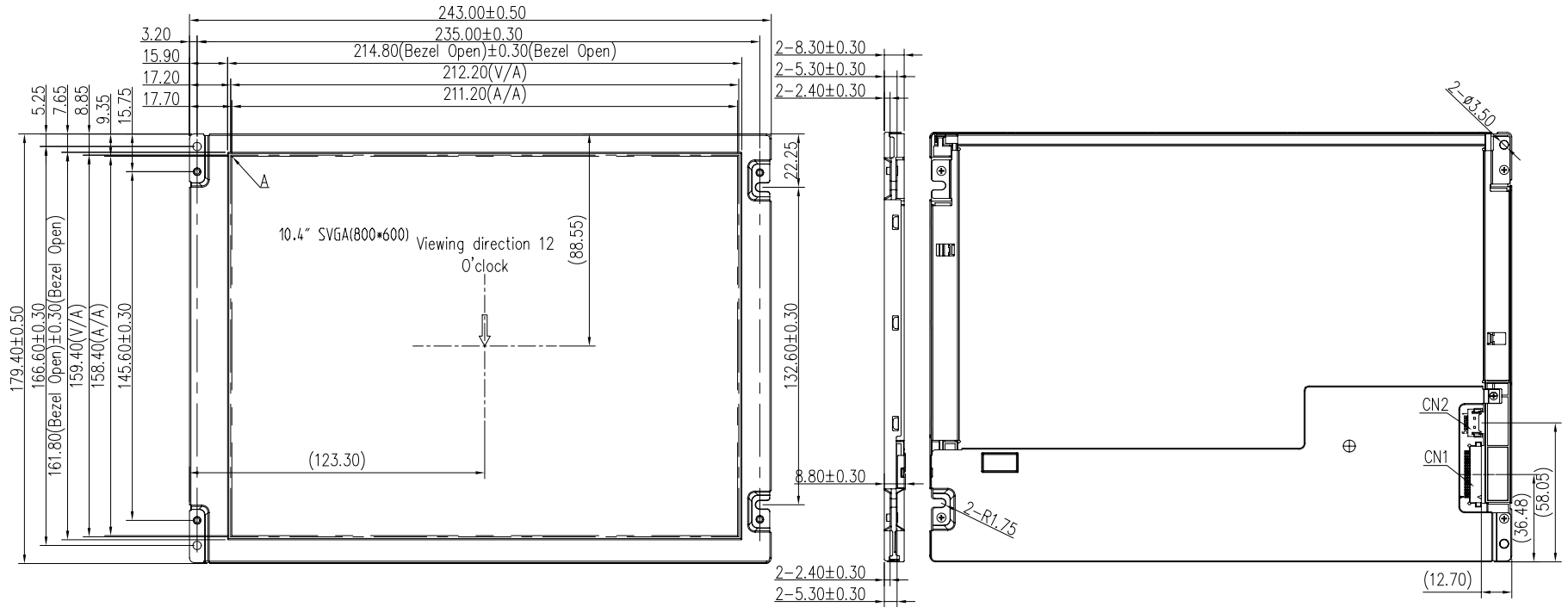

- NOTES:
1. Display Type: a-Si TFT;
  2. Backlight: 40-chips LED, 5 series, 8 Parallel;
  3. Gray Scale Inversion: 6 o'clock;
  4. Driver IC: Gate IC NT39211, Source IC NT39411;
  5. Matched connector: CN1 DF19G-20S-1C (or compatible);  
CN2 H208K-P05N-02B (or compatible);
  6. General Tolerance: ±0.3;
  7. Requirements on environment protection: RoHS compliant;
  8. Recommended Case Open Area should be less than Module V.A.

CUSTOMER APVL		DATE	2013/11/25
DRAWN	SCALE	TITLE	
DFTG CHK	UNIT	MI1040GT-8A	
ENGR CHK	mm	MODEL	
APPROVAL			
MULTI-INNO TECHNOLOGY CO.,LTD.		DWG NO	PAGE
		A	1/1